



CLICK - Lite **Smart GSM switch**

Manual

CONTENTS

1. PREFACE	3
2. SAFETY INSTRUCTIONS	3
3. FEATURES OF THIS DEVICE	4
3.1. Terminology.....	4
3.2. Features in the basic mode.....	4
3.3. Features in the extended mode	5
4. INSTALLATION OF THE DEVICE	5
4.1. Description of device	5
4.2. Insertion of a SIM card from operator	6
4.3. Signalling states.....	9
4.4. Availability of GSM network.....	9
4.5. Initial setting of the device.....	9
4.6. Rules for communication via SMS messages.....	11
4.7. Charging the battery	14
4.8. Adjustment of features in the initial mode	14
4.9. Adjustment of features in the extended mode.....	15
4.9.1. The ALARM feature.....	15
4.9.2. The REMOTE VOICE MONITORING feature	17
5. TECHNICAL DATA	17
6. ENVIRONMENTAL PROTECTION:	18
7. WARRANTY TERM AND CONDITIONS	18

* Zadako is a registered trademark of Zadako s.r.o. All rights are reserved.

* Zadako reserves the right to change or improve any one of the products described in this manual, even without prior notice of a customer.

1. PREFACE

CLICK - smart GSM switch is a compact device, primarily intended to indicate an unauthorised entry into a protected area. It is used in the interior, and it is possible to place it into an existing or newly built electric installation of the facility and in any room, where the motion sensor can detect the movement of people (about 5 metres). It is a general purpose and unique device and can be installed anywhere with supply voltage 100 - 240 V, both in horizontal and vertical position (on the wall, ceiling, etc.).

WARNING!

CLIK does not replace the professional securing device, does not guard the facility, only indicates an unauthorised entry of a person into the facility.

2. SAFETY INSTRUCTIONS

Safety of ZADAKO electrical device complies with relevant technical standards and safety regulations for electrical devices. But as a producer, we feel obligation to inform you with following instructions:

- The device is intended for indoor use.
- Handling with the device by other way than described in the enclosed operating instructions, may result in its damage or malfunction.
- The CLICK device is sensitive, handle it with care, avoid rough handling.
- Do not disassemble the device, neither try to fix it yourselves. Repair of the device should be performed by an authorized service centre.
- To reduce risk of fire and prevent damage, do not expose the device to effects of moisture, rain, source of open flames or to direct sunlight.
- Do not cover the device by metal objects.
- Do not use the device in service stations or near combustibles or chemicals.
- The manufacturer does not recommend to use this device for guarding of premises in which freely move domestic pets, because the motion sensor can respond to their movement.
- Keep the motion sensor clean. Presence of impurities may reduce reliability of the device.
- All safety precautions that apply to conventional mobile phones, apply also to this device.
- The device should be transported in its original packaging only, in order not to damage the motion sensor.
- Connection and installation of this electrical device may be carried out by a qualified person only. Verify that the installation space (space, department and environment) is suitable for electrical device.
- Provided warranty does not apply to devices on which were performed modifications or which were changed.
- Observe applicable regulations in your country and valid safety provisions.
- Comply with all precautions presented in this manual. Failure to observe this warning can result in serious or fatal injury.
- In the event that the device starts to be abnormally hot, a smoke is coming out of it, there is unusual smell or sound, stop using it. Immediately turn the main switch or protective breaker off and contact the service technician. Use of the device in such condition may result in a fire or electric shock.
- In the event that the device is damaged, or its cover is damaged, stop using the device. Immediately turn the main switch OFF and contact the service technician. Use of the device in such condition may result in a fire or electric shock.
- In the vicinity of the device do not use flammable sprays, liquids or gases, because they can cause a fire.
- Do not install the device at the place near to air conditioning or heating device. The resulting

- changes in temperature inside the device may cause failure, fire or electric shock.
- Do not install the device in a dusty place or at a place exposed to sooting or steaming, close to the kitchen line, bath or humidifier. It may present a risk of fire, electric shock or another failure.
 - Do not use the device in an environment with a temperature outside of the range set out in the instructions for use, as it may cause its malfunction or damage.
 - Only use batteries and accessories recommended by the manufacturer of the device. Otherwise, there is a risk of damaging the device or even of an explosion.
 - Batteries for CLICK device should be purchased directly from the manufacturer.

Important warning – device can be install to electrical system only by electrical qualified person. Please turn the main switch off before connection. Any manipulation needed removing the cover of CLICK may be carried out by a qualified person only.

3. FEATURES OF THIS DEVICE

3.1. Terminology

Light/Illumination - main illumination of a room or a night light on the switch

Main light - room illumination, controlled by CLICK

Night light - light on CLICK (white LED)

Arming = activation of guarding, i.e. activation of the motion sensor = alarm via GSM

De-arming =deactivation from guarding, i.e. deactivation of the motion sensor

3.2. Features in the basic mode

For utilization of these features the CLICK device does not require a SIM card from mobile network operator, nor a backup battery.

CLICK in this mode cannot give the information about an alarm via call to a mobile phone or via sending an SMS message. It is also not able to carry out monitoring or remotely control the light via SMS commands and to adjust other parameters of the device.

Control is carried out via two positions of the cradle:

Cradle Z - upper position of the switch

Cradle V - lower position of the switch

The following features are automatically functional:

- **The ILLUMINATION SWITCH feature:** pressing the cradle Z turns the light ON, pressing the cradle V turns the light OFF
- **The EMERGENCY LIGHTING feature:** in the event of a power failure in the facility, upon registration of a movement the white emergency LED light will go ON for 10 seconds. /only with connected battery!/
/

Other features in a basic mode is necessary to activate:

- **Feature WHITE LED LIGHT FOR PERMANENT ILLUMINATION:** by selecting this feature can be set the white LED light for permanent illumination, controlled by the switch.
- **Feature AUTOMATIC SWITCH OF THE LIGHT:** in the dark it registers movement of a person and lights up the main illumination of the area for 20 seconds.

- **Feature WHITE LED LIGHT IN A DARK:** Upon registration of movement of a person in a dark it automatically switches the LED light for 20 seconds.

3.3. Features in the extended mode

Features in the extended mode require inserting of a SIM card from the operator and connection of a battery.

- **The ALARM feature:** Surveillance of the area; in the case of entry of an unauthorised person (the thief) into guarded room (e.g. hallway of an apartment, office, warehouse, garage, garden house, entrance room at the cottage, etc.) it sends an SMS and calls the default phone numbers.
- **The REMOTE MONITORING feature:** if necessary, it is possible to perform sound monitoring of a guarded room (to check the children in the room, to check unauthorised entry into the room until you check it personally)
- **The PRESENCE SIMULATION feature:** in the event of absence, an option simulating the presence by turning lights ON and OFF via remote light control by SMS, or by a program
- **The TEMPERATURE MEASUREMENT feature:** the remote temperature measurement in a room

4. INSTALLATION OF THE DEVICE

4.1. Description of device

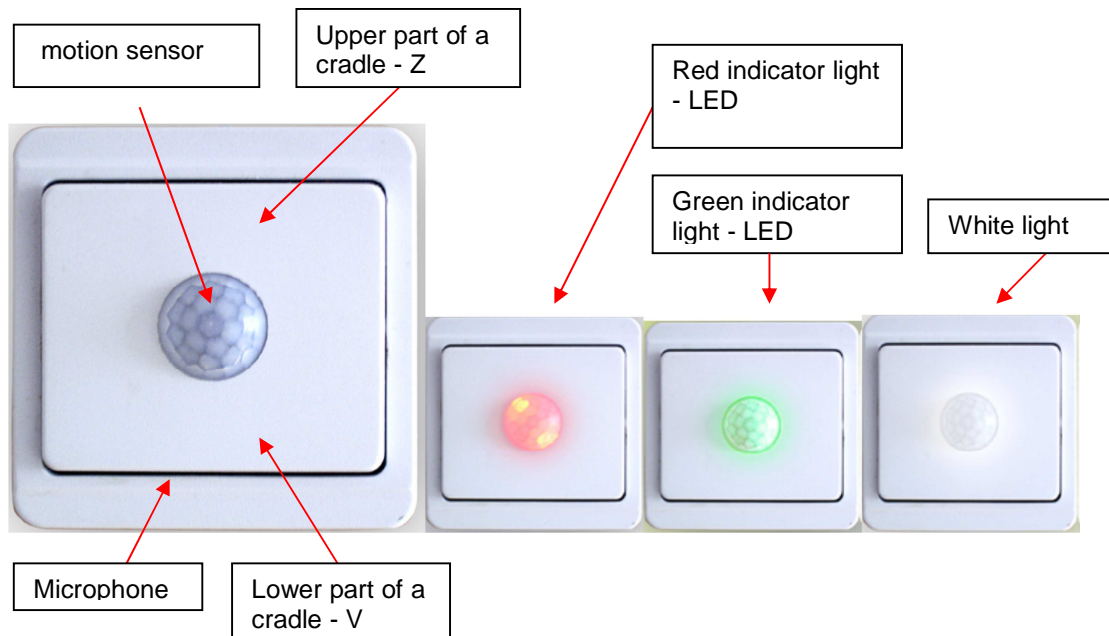

4.2. Insertion of a SIM card from operator

If you want to use the device with extended features, it is necessary to use a SIM card from the operator

1. On the SIM card, which you want to insert into the device check, whether it has turned off the protection by a PIN code. You can verify it by inserting the card into a conventional mobile phone. If the phone logs on to the home network without asking your PIN code, protection by PIN code is turned off. If your phone asked for your PIN code, disable this protection in the phone menu (Settings).
2. Cancel all redirects to a voicemail.
3. Check whether the SIM card has active CLIP service. You can find it out by entering the SIM card into a mobile phone and then call it from another phone. If you see who is calling, the CLIP service is active. If display of your mobile phone does not show who is calling, activate the service from your mobile operator.
4. Take a flat item /e.g. screwdriver/ and shuck out the cradle switch (see fig. Insertion of the SIM card).
5. Rotate the device, so that you can see its bottom part. During every insertion of a SIM card is required that the battery is not connected to the connector BAT, and that the control and power module is not connected to connector K1. The device must not be under supply voltage! If these conditions are met, slide the SIM card into the SIM card holder, as shown in fig.
6. Connect the BAT connector. Then connect the power and switch module into connector K1.
7. Insert the whole device including power module into the conduit junction box, intended for installation of the switch.
8. Secure the device by two screws. Mount the cradle of a switch as follows: insert one clevis into one side of a frame and the other clevis is inserted by pressing the cradle against a frame.
9. Turn ON the supply voltage. The device is ready for extended functionality.

ATTENTION!

- If you slide the prepaid SIM card (EASY, PRIMA) into the CLICK device, you must check status of its credit and its validity, because if the credit is spent, or validity of a SIM card expires, the CLICK stops working!
- The precondition for installation is presence of the phase and the zero conductors in the switch electric mounting box, to ensure supply of the device. Installation should be performed by an employee with electro-technical education.
- Do not perform any manipulation with the device, when the cover is removed and the power supply is ON. There is a risk of accident due to electric shock. Do not try to exchange the SIM card on installed device.

Insertion of a SIM card:

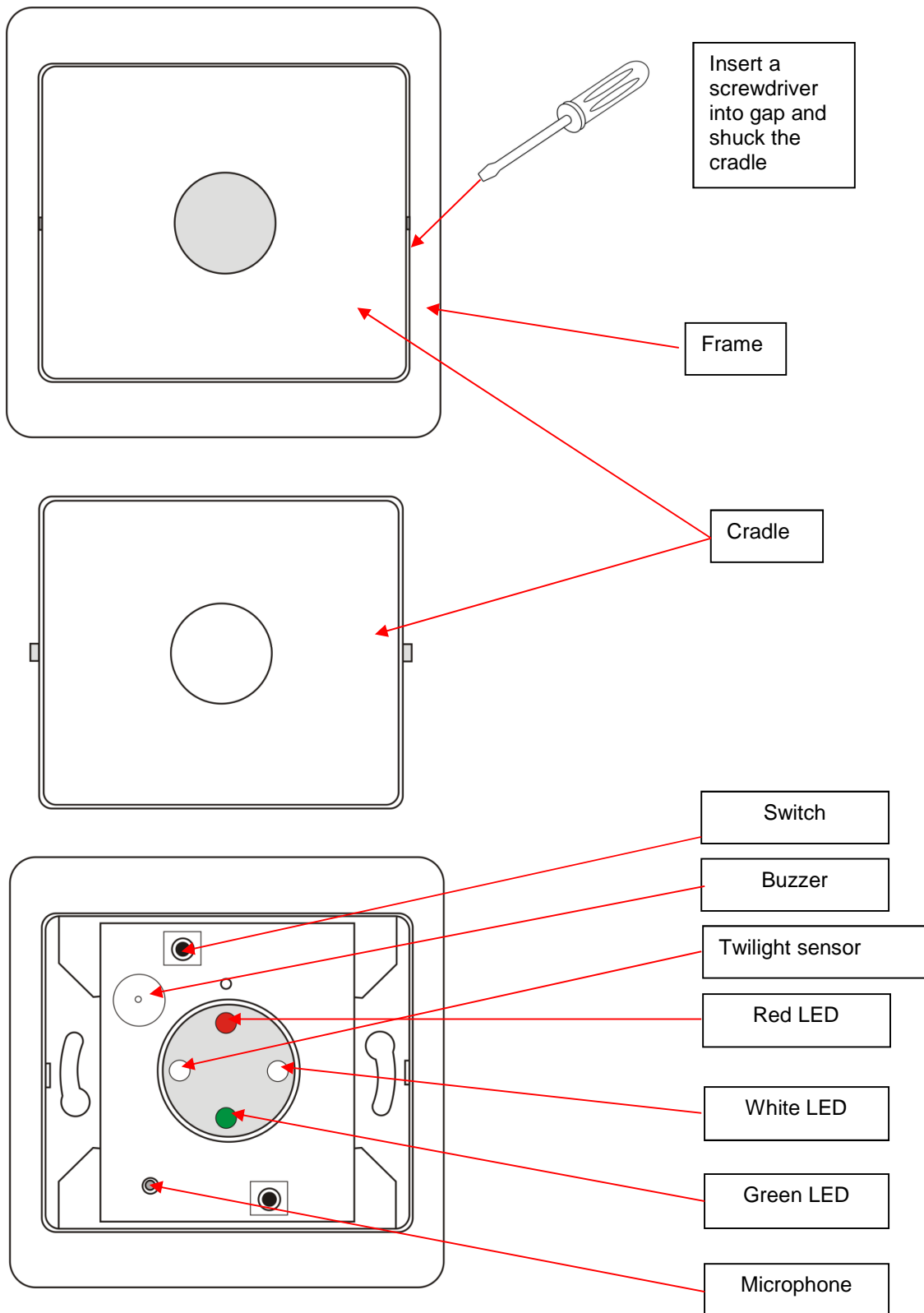

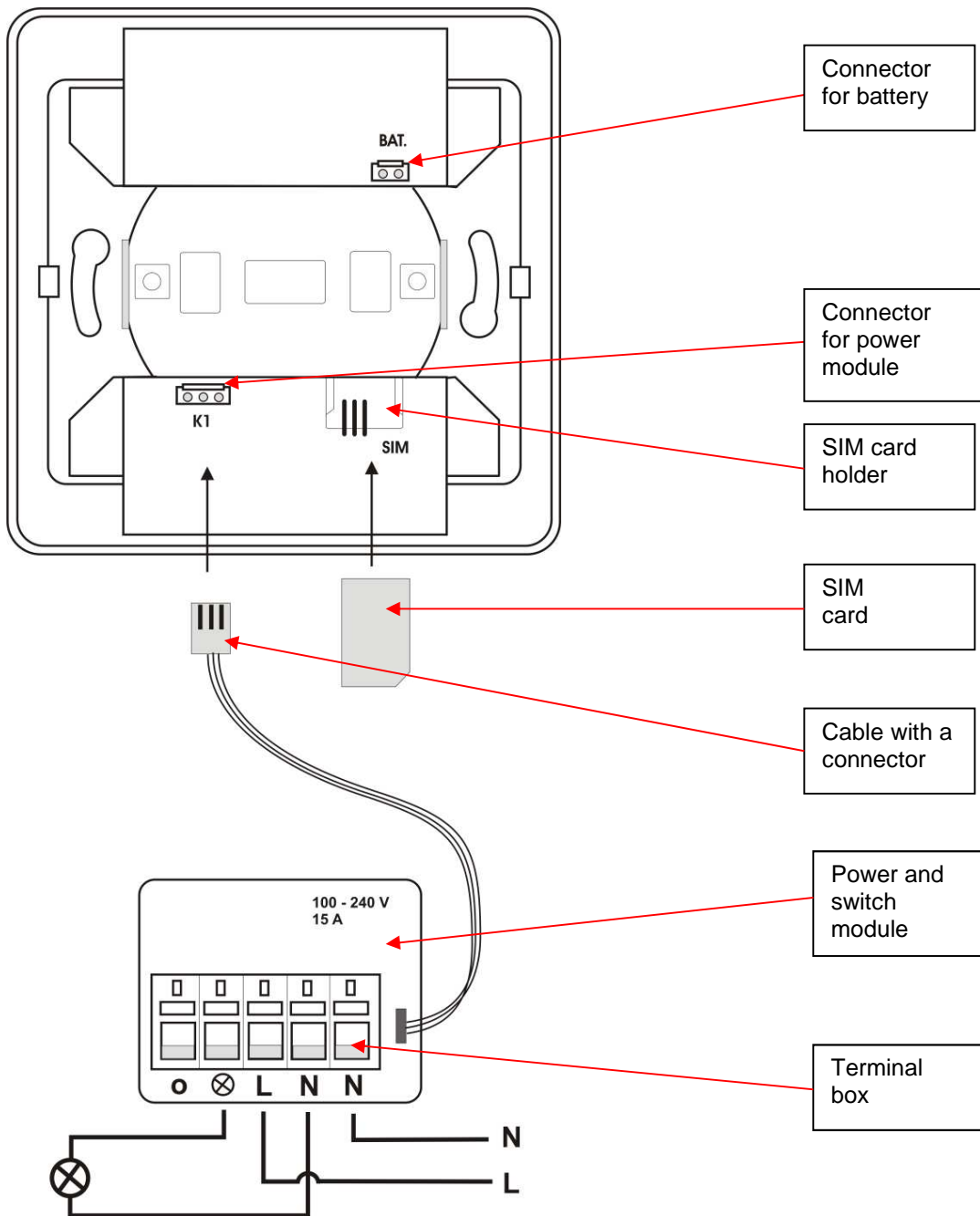

4.3. Signalling states

<i>Description of the state</i>	<i>LED light</i>			<i>Acoustic buzzer</i>
	<i>Red</i>	<i>Green</i>	<i>White</i>	
Entry to the program	-	-	1s/1s	-
Confirmation of the function	-	-	-	1 beep
Guarding	Permanent light	-	-	-
Short press of a cradle	-	-		1 beep
Long press of a cradle	-	-		2 beeps
Exit time	1 second	-	-	Beeps
Rejection of a feature	-	-	-	Long tone
Error Message	-	See Chap. 4.4.	-	Long tone
Captured correct SMS	-	-	-	1 beep

4.4. Availability of GSM network

The GSM network must be available for proper function of the CLICK device. Indication of GSM network availability is presented in a table. If the GSM network is unavailable, the cause may be as follows:

- SIM card is not inserted into the device,
- PIN code on the SIM card is not deactivated,
- Weak signal of the GSM network (weak coverage of the operator),
- GSM network not available (outage of network of the operator).

During installation of the device check signal strength in the vicinity of the device using other mobile phone (according to signal icon on the display). The device may be installed only on a place with adequate signal from the operator.

Indication of problems during arming /green LED/:

- **Green LED flashes once:** Backup battery not inserted
- **Green LED flashes twice:** Battery discharged
- **Green LED flashes three times:** GSM is not registered (no SIM, PIN is turned ON, the operator is unavailable ...)
- **Green LED flashes four times:** Missing setting of at least one phone number, where to call

For simplicity is in case of several errors indicated only error with lower number of flashes.

4.5. Initial setting of the device

Initial setting is a set-up of values from the manufacturer. When the device is turned ON for the first time, the values are set as follows:

CONSTANT PARAMETERS:

Ringling time = 20 seconds

- it is an amount of time for how long the device shall call to one phone number during an alarm, until

someone picks the call up

Number of rings = 3 attempts for each phone number

- how many times has the device to ring to one phone number during alarm

Voice monitoring time in a de-arming state= unlimited

VARIABLE PARAMETERS:

Password = abcd

- it is used to control the device via SMS messages; it is recommended to change the password and make a note of it. The device can not be controlled via SMS messages without correct password. It may contain both letters and numbers.

Sensitivity of PIR detector = 20

- it is used to adjust the sensitivity of PIR detector; the higher the value, the lower sensitivity.

Entry time = 10 seconds

- time, during which the de-arming person have to de-arm the room after arrival

Exit time = 30 seconds

- time, during which the arming person have to leave the room after arming.

Time delay of the light after movement = 10 seconds

- time after which the light turns ON after movement in the armed room

Ringling time to a phone number upon alarm = 25 seconds

- ringling time of an device to a phone number upon alarm

Voice monitoring time upon alarm or emergency call = 60 seconds

- time from a moment when you receive a call incoming from the CLICK device in case of an alarm or upon an emergency call. voice monitoring upon alarm ends automatically after 5 minutes.

Max. number of alarms at one arming = 2

- used for example for protection of your credit during false alarms. adjusted is maximum number of calls / SMS messages in case of an alarm.

Deactivation Time = 10 minutes

- time between individual alarms. new alarm can be launched after elapsing of this time.

Text of information messages

- messages informing about following events:

Denomination	Event	Default text of SMS message
S0	Name	CLICK
S1	Alarm	Alarm
S2	Low battery	Battery low
S3	Battery charged	Battery OK
S4	Power failure	230V Error
S5	Power supply restored	230V OK
S6	Emergency call	Emergency Call
S7		Reserve

The Click device allows transmission of information SMS messages about alarm, low battery, battery charge, electrical power failure, restoration of power supply and emergency call. All messages are sent in the arming state (ARM) only. Information SMS message arrives on your mobile phone always in a form S0 + S1 or S0 + S2 etc., therefore e.g. **CLICK Alarm** or **CLICK Battery low**. The information SMS message about electric power failure is sent after 10 min failure, while about restoration of electric power immediately.

Return to the initial setting

This can be done by a service and/or installation technician with relevant qualification only!

If you want to go back to the initial setting, disconnect the power supply to the power module. Then disconnect the CLICK from power module. Disconnect the battery. On the CLICK device keep the button pressed on either side and reconnect the battery - keep the cradle of switch pressed until double beep is heard. Then release the switch - cradle. The device is set up to the factory values. CLICK can be re-installed.

ATTENTION! After restoration of factory values (reset) all telephone numbers are cleared and for further use they have to be recorded again, or other telephone numbers should be recorded!

4.6. Rules for communication via SMS messages

The device shall be set up via sending configuration SMS message (message, by which you set individual parameters) from a mobile phone to the phone number in the CLICK device. You can set all variable parameters. For functionality of the device is required just set-up of phone numbers; other parameters may remain those that are in the initial settings from the factory.

The programming SMS message can be sent also from a number, which is not defined in phone book of CLICK; however, you need to provide the correct password. It is therefore important to change the password and entrust it only to those persons who will control the CLICK device. SMS messages with incorrect or no password (e.g. also advertising operator messages) sent to the phone number of the SIM card are in CLICK automatically deleted. Calls from unknown phone numbers to CLICK device are ignored (i.e. those users cannot perform monitoring, neither de-arming)! Numbers included in the list of CLICK device must not have an active CLIR service, because the device cannot identify a phone number from which a call is coming!

The device indicates receipt of SMS message (in de-arming state) as follows:

If password is correct - according to the table for signalization,

If password is incorrect - according to the table for signalization.

Rules for writing SMS messages

- Password must be at the first position, "?" must be at the last position!
- When writing text of SMS message be sure to follow spacing (space is depicted as _).
- There is no need to distinguish between small and capital letters.
- Text of information messages S0 - S7 must end by a character #, phone numbers not! (See example.)

Examples of configuration SMS messages, in which you set all parameters /max. 20 characters per command/:

A/ **abcd_?**

B/ **abcd_PWD=adam_T1=09xxxxxxx_T2=09xxxxxxx_T3=#_?**

C/ **abcd_S0=home_alarm#_S1=The Thief#_S2=low_bat#_S4=electr_OFF#_S5=electr_ON #_?**

Explanatory notes:

A/

abcd - password of the device (4 characters)

- means a space /underline/
 - ? - The requirement for sending the initial list of settings
- B/**
- abcd - password of the device (4 characters)
 - means space
 - PWD=adam - change of password from "abcd" to "adam"
 - T1=09xxxxxxx, T2=09xxxxxxx - phone numbers 1-4 (in our example are set only 2 phone numbers)
 - T3=# - deletion of the phone number
 - ? - The requirement for sending the initial list of settings (in our case also including newly defined phone numbers)
- C/**
- abcd - password of the device (4 characters)
 - means space
 - S0 - change of the device/facility name
 - S1... S5 - change of default text of information messages (max. 20 characters)
 - ? - Sending of the initial list of settings (in our case also including newly defined texts of information messages)

The manufacturer recommends to send SMS messages with a question mark at the end, so that you are sure that you have performed a change of settings or of any other command correctly. After sending an SMS message with a question mark at the end to the phone number of a CLICK device, you will receive the information not only about settings of the device, but also about the current mode, therefore whether the device is armed:

abcd T1=09xxxxxxx T2=# T3=# T4=# SEN=20 AT=10 DT=20 TZAP=10 TRING=25 TCALL=60 NALARM=2 TSLEEP=10 (DISARM)

Explanatory notes:

- abcd - current password
- T1=09xxxxxxx - defined phone number
- T2=#, T3=#, T4=# - not defined phone numbers
- SEN=20 - sensitivity of PIR detector (20=sensible, 50=less sensible) /range: 15 through 60/
- AT=10 - entry time (in seconds) /range: 0 through 120 /
- DT=20 - exit time (in seconds) /range: 10 through 120 /
- TZAP=10 - time delay of the light after movement (in seconds) /range: 5 through 120 /
- TRING=25 - ringing time to a phone number upon alarm (in seconds) /range: 20 through 60 /
- TCALL=60 - restriction of voice monitoring time (in seconds) /range: 10 through 240 /
- NALARM=2 - max. number of alarms at one arming /range: 1 through 100 /
- TSLEEP=10 - time between individual alarms (deactivation time) /range: 5 through 240 /
- (DISARM) - current surveillance status

Configuration commands of SMS messages:

- PWD=1234 - change of password
- ARM - arming via SMS
- SARM - silent arming
- DISARM - de-arming via SMS
- T1=09..... - entry of a phone number T1 through T4 =# deletion of a phone number
- PWD=AB12 - entry of a new password
- SEN=30 - sensitivity of PIR detector (20=sensible, 50=less sensible - to modify another scale /range: 15 through 60 /
- DT=30 - exit time [sec] /range: 10 through 120 /
- AT=20 - entry time [sec] /range: 0 through 1200 /
- SIGON - indication of arming state – ON /permanent RED led lights/
- SIGOFF - indication of arming state – OFF /RED led doesn't light/

TZAP=30 - time when the light is ON upon movement [sec] /range: 5 through 120 /
 TRING=20 - ringing time to a phone number upon alarm [sec] /range: 20 through 60 /
 TCALL=60 - restriction of voice monitoring time [sec] /range: 10 through 240 /
 NALARM=3 - max number of alarms at one arming /range: 1 through 100 /
 TSLEEP=30 - number of minutes, how long after alarm will not be recorded another alarm
 max=240 /range: 5 through 240 /
 TCALL=120 - restriction of voice monitoring time in seconds max=240 /range: 10 through 240 /
 U1T=10 - delayed reporting of the power supply outage in minutes max=120 in minutes
 /range: 5 through 120 /

Example 1:

Query SMS sent to CLICK:

ABCD ? - Initial list of settings
Reply to query: from CLIK:

abcd - current password on CLICK
 T1=0903... - defined phone numbers
 T2=# - deleted phone number
 T3=# - deleted phone number
 T4=# - deleted phone number
 SEN=20 - sensitivity of PIR detector. 20=sensible, 50=less sensible
 AT=10 - entry time
 DT=20 - exit time
 TZAP=10 - time delay of the light after movement /in seconds/
 TRING=25 - ringing time to a phone after alarm /in seconds/
 TCALL=60 - restriction of voice monitoring time [sec]
 NALARM=2 - max number of alarms at one arming
 TSLEEP=30 - number of minutes, how long after alarm will not be reported another alarm
 U1T=10 - delayed reporting of the power supply outage in minutes
 (DISARM) - current surveillance status

Example 2:

Query SMS sent to CLICK:

ABCD ?S - extended list of settings – used texts (each text max 20 characters)

Reply to query: from CLIK:

abcd
 S0=CLICK # - name for CLICK
 S1=Alarm # - alarm message
 S2=Battery low # - low battery
 S3=Battery OK # - battery OK (recharged after discharging)
 S4=230V Error # - power supply outage
 S5=230V OK # - restoration of power supply
 S6=Emergency Call # - emergency call (for special version)

Arming via SMS	abcd_ARM
De-arming via SMS	abcd_DISARM

Entry of the phone number from a list (applies also to T2, T3 and T4)	abcd_T1=09xxxxxxxx
Deletion of a phone number from a list (applies also to T2, T3 and T4)	abcd_T1=#
Change of password from "abcd" to "klmn".	abcd_PWD=klmn
Adjustment of PIR detector sensitivity to 30 seconds	abcd_SEN=30
Adjustment of the exit time to 30 seconds	abcd_DT=30
Adjustment of the time of light ON at movement to 30 seconds	abcd_TZAP=30
Adjustment of the ringing time to a phone number upon alarm to 20 seconds	abcd_TRING=20
Adjustment of the voice monitoring time to 60 seconds	abcd_TCALL=60
Adjustment of max. number of alarms at one arming	abcd_NALARM=3
Change of the device/facility name	abcd_S0=Home_alarm#
Adjustment of time between individual alarms to 10 minutes	abcd_TSLEEP=10
Change of text of the information message from original to „The Thief“ (applies also to S2, S3, S4 and S5)	abcd_S1=The Thief#
Obtaining of configuration SMS message - set phone numbers, parameters and device status	abcd_?

When using device with extended features, the device calls and sends SMS to phone numbers in the order in which they are recorded in **the list of phone numbers** of the CLICK, therefore first to T1, then T2 etc.

4.7. Charging the battery

CLICK is permanently supplied from the mains. The battery is automatically recharged by the electronics. Fully charged battery lasts without recharging for approximately 2 hours. When the battery is low, at turned off power supply is indicating the red LED - starts to flash once every 4 seconds, when it is completely empty, the device is switched off. After connecting of the power supply CLICK beeps and the red LED will permanently glow until being recharged to the required level. Battery can be charged only at positive temperatures!

4.8. Adjustment of features in the initial mode

- 1 - Activation of the feature **WHITE LED LIGHT FOR PERMANENT ILLUMINATION:**
(the main light is functional - controllable, if turned ON, the white LED light gradually goes off. When the main light goes off, the white LED light starts to glow)
- Press and hold the cradle V for longer time than 4 seconds (the night white LED light on the switch 1:1 will start to flash),
 - Consequently, once momentarily press the cradle V (one confirming beep may be heard - the feature is activated).

- 2 - Activation of the feature **CONTROL THE NIGHT LED LIGHT BY A SWITCH:**

(main light remains switched off)

- Press and hold the cradle V for longer time than 4 seconds (the white LED light on the switch 1:1 will start to flash),
- Consequently, press the cradle V twice for a short time (one confirming beep is heard - the feature is activated).

3 - Activation of the feature **WHITE LED LIGHT ON UPON MOVEMENT IN THE DARK:**

- Press and hold the cradle V for longer time than 4 seconds (the white LED light on the switch 1:1 will start to flash),
- Consequently, press the cradle V three times for a short time (a confirming beep is heard - the feature is activated).

4 - Activation of the feature **MAIN LIGHT ON UPON MOVEMENT IN THE DARK:**

- Press and hold the cradle V for longer time than 4 seconds (the white LED light on the switch 1:1 will start to flash),
- Consequently, press the cradle V four times for a short time (a confirming beep is heard - the feature is activated).

Deactivation of these features 1,2,3 and 4 is carried out as follows:

- Press and hold the cradle V for longer time than 4 seconds (a confirming beep is heard).

If there is nothing to be deactivated, the LED light on the switch starts to flash and activation of one of other features is expected. If you do not press the cradle V within 30 seconds, nothing is activated and activated features are deactivated.

4.9. Adjustment of features in the extended mode

4.9.1. The ALARM feature

The Click device provides information of entry of an unauthorised person into the guarded room by sending SMS message and ringing to the default phone numbers of the device phone book. Entry of a person is registered by a motion sensor, which is located on the cradle of the device, therefore proper location of the device is very important. The manufacturer recommends to locate it on the wall, close to the door or window.

The motion sensor is a sensor reacting on a movement of a person in its angle of view. Before you start using CLICK, it is recommended to perform the test of motion sensor, to see if it has a good coverage of passers-by and if it covers your selected safety zone.

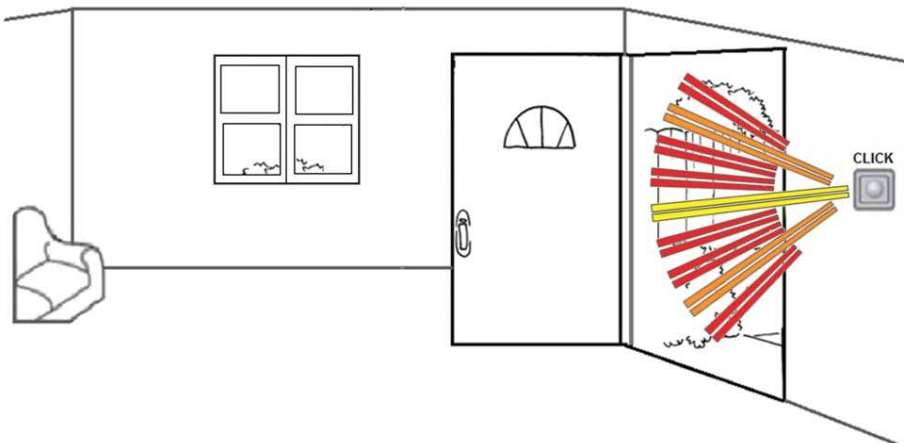

Test of the motion sensor is linked with arming and is performed in an de-armed mode. It is launched by longer holding of the cradle Z. It is terminated by a brief repeated press of the cradle V. When the motion sensor is active, but does not capture any movement (do not move), the device beeps in one second intervals. When you move, the CLICK indicates capturing of the movement by permanent whistling. When you are moving, the sensor captures your movement and cannot perform arming, but from a moment when you stop moving (you leave the room), the CLICK starts to arm (beeps once per second). Last 5 seconds of exit time are indicated by fast beeping. If, during the exit time you return to the room, CLICK starts to whistle again and new arming again starts in a moment, when the device does not capture any movement. Length of the exit time is adjustable and it takes so many seconds, how many is set in the parameter "exit time", therefore **DT**. The arming can be cancelled during exit time by a brief pressing of the cradle V.

Eventual issues during arming (test of the motion sensor) can be caused by:

See section: 4.4.

How to arm:

Arming: (Only if there are no problems described in section 4.4.)

In any state by pressing and holding (Z) for a period longer than 4 seconds. It beeps and the arming process starts.

- By longer pressing of the cradle Z
- or
- by sending an SMS message to the phone number of the CLICK device (if you are not present in the guarded area).

SMS must be in a form: **abcd_ARM**. If you want to have arming confirmed by the CLICK device to your mobile phone, at the end of SMS add a question mark: **abcd_ARM_?**. Arming via SMS message is performed immediately after receipt of the message, without audible indication of the exit time; just the green LED goes off.

- It is possible to arm/de-arm also via SMS in a form

[password] ARM - arming with exit time

[password] SARM - silent arming without exit time

[password] DISARM - de-arming via SMS

How to de-arm:

- By calling from a pre-defined number in the phone book to a phone number of the CLICK device, before entry into the guarded area. The CLICK device automatically ends the call, only then is the de-arming completed and you can walk into the room. Unknown calls are rejected.
- or
- By sending an SMS message to the phone number in the CLICK device in a form: **abcd_DISARM**.

ATTENTION!

Before leaving the room close all windows and doors, in order to prevent the creation of false alarms. The false alarm may also arise at start up of the air conditioning, heating or by free movement of animals in the room.

Violation of a guarded area:

If an unauthorized person enters into the guarded area (where the CLICK device is located), the device sends out a predefined SMS message to all preset phone numbers and also calls them. (If you pick up the

call, you can hear what is going on in the guarded room, but maximum for 5 minutes.) The device does not indicate anything by sound or visually, so that the unauthorized person does not detect that someone knows about his/her presence. After sending notification about an alarm, the CLICK device remains in an armed state and another message of violation will report not sooner than after elapsing of 15 minutes (thus eliminates messaging about violations by the same person).

4.9.2. The REMOTE VOICE MONITORING feature

In the de-armed state

When you call the phone number in the device, you can hear sounds in the guarded room. You can monitor the voice for an unlimited period. Only person with a phone number defined in the phone book of the CLICK device (see 4.6) is authorized to perform voice monitoring.

Upon creation of an event

You can monitor given room also when the CLICK device call you in case of an alarm; just pick up an incoming call. Voice monitoring will end up automatically after 5 minutes. If you want it to end it sooner, end the call; if you want to monitor for a longer time, you need to set up the parameter **TCALL** to a greater value. During alarm or emergency the monitoring cannot be performed by several persons at the same time; the next person must always wait until previous person ends monitoring (the device always call individual numbers in the order in which they are stored in the phone book).

5. TECHNICAL DATA

CLICK – Lite:

GSM module Dual Band GSM/GPRS: 900/1800 MHz

Motion sensor (360°, range 5 m)

Power supply: 3.7 VDC

Standby time: 2 hours from the battery

Max. current: 200mA

Dimensions: 80 x 80 x 33 mm

Weight: 60g

Temperature range: 0°C up to + 55°C

Power and switch module:

Electrical ratings: 100 - 240 V

Switching current: 10A

Dimensions: 35 x 38 x 23 mm

Weight: 28g

Temperature range: 0°C up to + 55°C

Accessories:

Battery: 350mAh, 3.7V

Dimensions: 19 x 42 x 7 mm

Weight: 10g

6. ENVIRONMENTAL PROTECTION:

ATTENTION!

The device has built-in rechargeable batteries. Do not try to replace them; give it to a professional service.

Prefer recycling of packaging materials and old appliances.

Plastic bags of polyethylene (PE) hand over to the collection centre of material for recycling.

Recycle the appliance at the end of its life:

The symbol on the device or its packaging indicates that this device does not belong to domestic waste. It is necessary to take it to the collection centre for recycling of electrical and electronic device. Ensuring proper disposal of this device will help to prevent negative consequences for the environment and human health. More detailed information about recycling of this product you can find at relevant local authorities, services for domestic waste disposal or in the store where you purchased this device.

7. WARRANTY TERM AND CONDITIONS

The certificate of warranty belong to the sold product of corresponding number and its accessories. For each claim is necessary to submit this certificate of warranty to the repair shop - seller. Store it carefully in your own interest. **For our products we provide 24 months warranty from the date of sale or delivery of the product** after submission of a duly completed and endorsed certificate of warranty, proof of purchase or delivery note.

The seller is obliged to hand over the device to the customer complete and packaged. In the certificate of warranty he must fill the name of the product, type designation, to enter serial number, as well as other necessary identification data of the product. The certificate of warranty card must also include the date of sale, the stamp of the shop and signature of the seller. All the above information must be written into the certificate of warranty immediately upon sale of the product in an indelible manner. Incompletely filled certificate of warranty or a certificate of warranty with unduly modified (retyped) content of original data, is invalid and void. Be sure to keep not only certificate of warranty and confirmation of purchase, but also a copy of document from repair shop, in which the service centre confirms performance of repair under warranty, in order to smooth the application of any claim arising from warranty terms and conditions.

The warranty does not apply to any damage caused by natural wear and tear of the device, its overload or incorrect handling (in conflict with the instructions for use). It also does not apply to instruments, on which was at the time of valid warranty performed any intervention outside of authorised repair shops, which have been damaged by a natural disaster or otherwise, or instruments, which have been handed over to (sent) to assess and repair in a disassembled state or incomplete.

Damages incurred as a result of faulty material or non-compliance with the technological manufacturing process, will be within the warranty period removed at no charge in a form of repair of the device or its replacement for a new device of the same type. You can only apply requirements resulting from the guarantee provided, that faulty device will be handed over (sent) to the seller or service centre in a not disassembled state.

The warranty period shall be extended by a period, since the customer filed a claim for warranty repair at the designated service centre, until date when he was required to take-over the repaired device after completion of the repair. All data contained in the certificate of warranty and in the confirmation of repair must be legible and certified by the signature of the service technician. If it is determined, that the device failure does not fall under scope of the guarantee, the costs associated with repair of the device and work of the service technician shall be borne by the owner of the device.

The manufacturer accepts no responsibility for overdraft of funds on the card of the operator in the event of

an incorrect setting of the device or failure to observe the instructions in the manual.

The manufacturer reserves the right to make changes in the manual.

MANUFACTURER:

ZADAKO, spol. s r.o.
Segnáre 17
841 03 Bratislava
Slovakia

Phone: +421 (0)2 6453 1086
Fax: +421 (0)2 6453 1084
e-mail: zadako@zadako.com
office@zadako.sk
www.zadako.com

